

WORX®

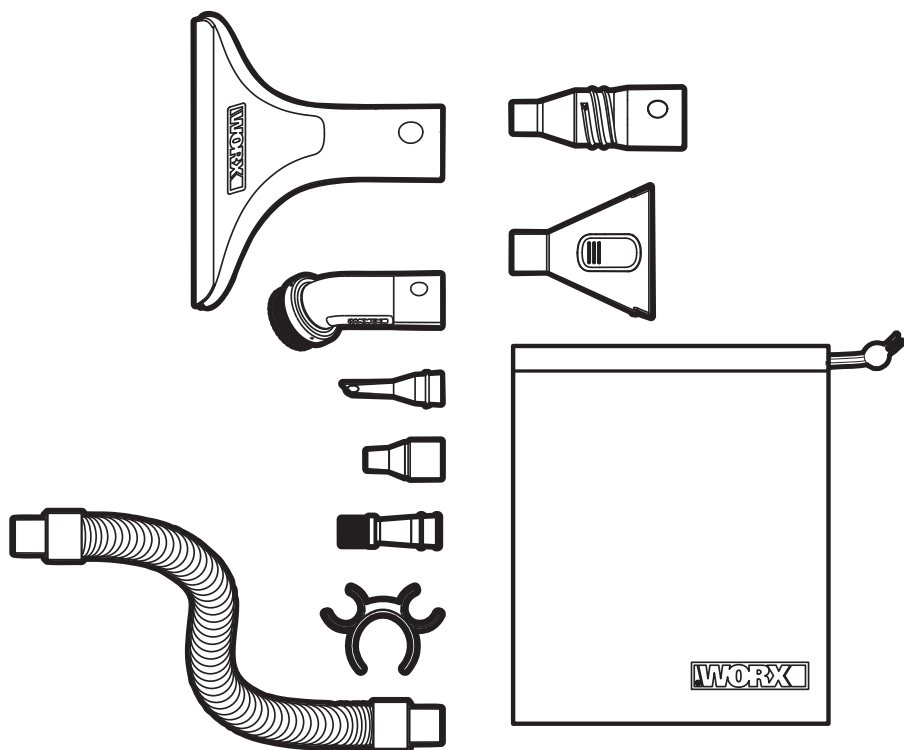

WORXAIR™ Attachments

EN

P03

Accessoires WORXAIR™

F

P08

Accesorios WORXAIR™

ES

P13



HELPLINE NUMBER
1-866-354-WORX (9679)

WA4091

Fits models: WG545 series, WG565 series, WG575 series

S'adapte aux modèles suivants: Série WG545, Série WG565, Série WG575

Para los modelos: Series WG545, Series WG565, Series WG575

WARNING!

User must read the product manual to fully understand this product prior to use.

CAUTION!

The user must wear the appropriate clothing and safety gear when operating this product. Be aware of all bystanders, pets and objects in a close proximity. Thoroughly inspect the area where the equipment is to be used and remove all stones, sticks, wires, and other foreign objects.

1. WIDE NOZZLE

2. DUST BRUSH

3. INFLATOR NOZZLE

4. DUST TUBE

5. ACCESSORY CLIP HOLDER (CONTAINS 3 AND 8)

6. EXTENSION HOSE

7. SHORT TUBE

8. DETAIL BRUSH

9. DEFLATION COVER

10. ACCESSORY BAG

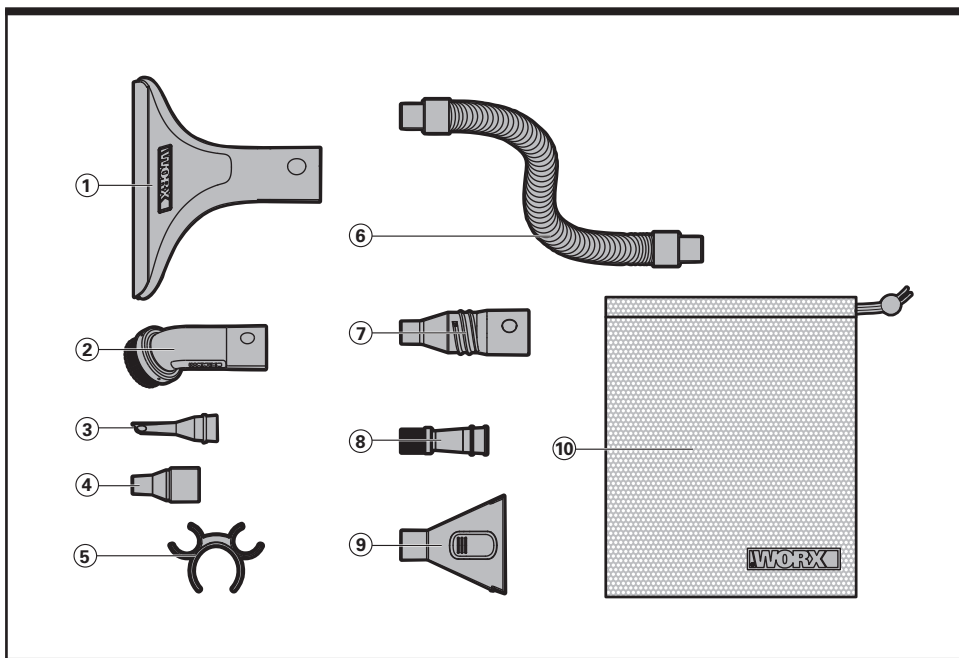

ASSEMBLY AND OPERATION

1. SHORT TUBE APPLICATION:

Attach the Short Tube (7) as shown in Fig. A1:

Also to be used as an adapter for other WORXAIR™ attachments.

Operate according to Fig. A2:

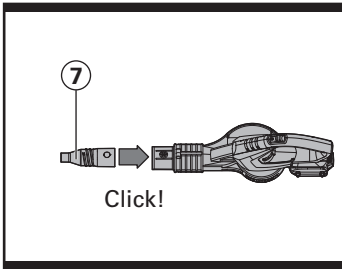

A1

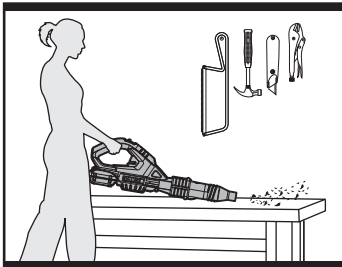

A2

4

2. DUST BRUSH APPLICATION:

Attach the Dust Brush (2) as shown in Fig. B1.

Operate according to Fig. B2:

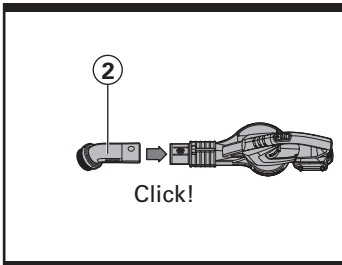

B1



B2

3. DUST TUBE APPLICATION:

Attach the DustTube (4) as shown in Fig. C1. Must use ShortTube (7) and Extension Hose (6).

Operate according to Fig. C2:

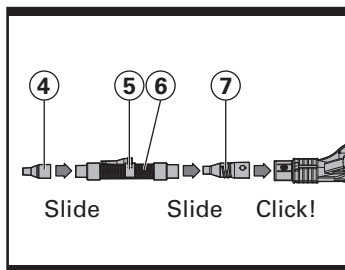

C1

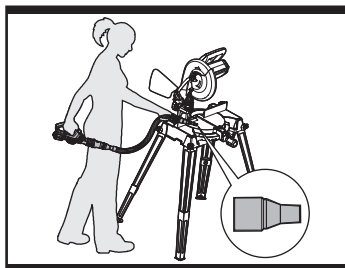

C2

4. DETAIL BRUSH APPLICATION:

Attach the Detail Brush (8) as shown in Fig. D1. Must use ShortTube (7), Extension Hose (6), and DustTube (4).

Operate according to Fig. D2:

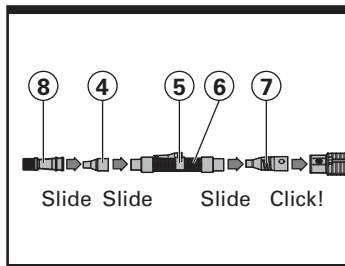

D1

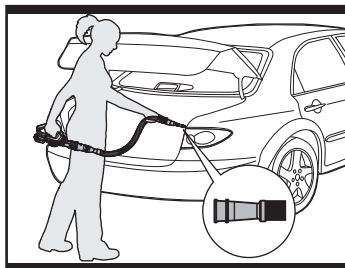

D2

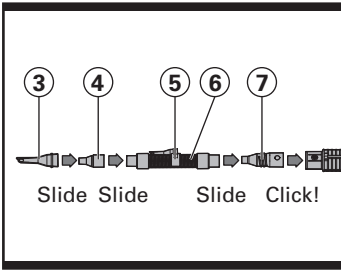

E1

5. AIR INFLATOR NOZZLE APPLICATION:

Attach the Air Inflator Nozzle (3) as shown in Fig. E1. Must use Short Tube (7), Extension Hose (6), and Dust Tube (4).

Operate according to Fig. E2:

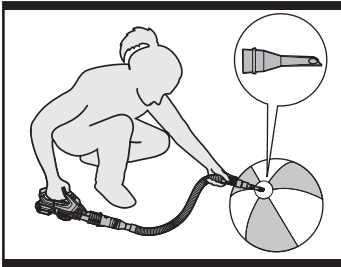

E2

6

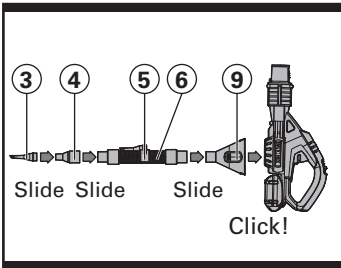

F1

6. AIR DEFLATOR APPLICATION:

Attach the Air Deflation Cover (9) as shown in Fig. F1. Must use Extension Hose (6) and Dust Tube (4). Air Inflator Nozzle (3) or Dust Tube (4) can be used depending on the object.

Operate according to Fig. F2:

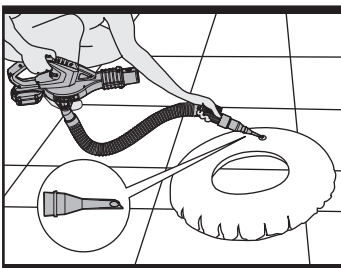

F2

7. WIDE NOZZLE APPLICATION:

Attach the Wide Nozzle (1) as shown in Fig. G1:

Operate according to Fig. G2:

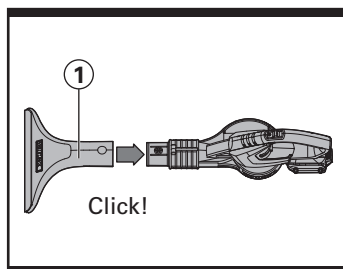

G1

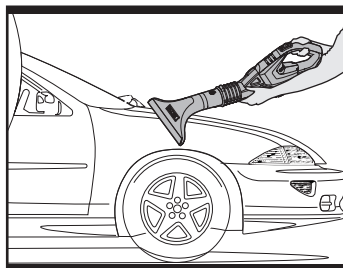

G2

AVERTISSEMENT!

Veillez lire les instructions importantes dans ce manuel de sécurité pour comprendre à fond ce produit.

ATTENTION!

L'utilisateur doit porter des vêtements et un équipement de sécurité appropriés lors de l'utilisation de cet appareil. Soyez conscient des personnes, des animaux et des objets qui vous entourent. Inspectez soigneusement le lieu dans lequel vous allez utiliser l'appareil et retirez-en les pierres, les bâtons, les fils, les os et autres objets.

1. BUSE LARGE

2. BROSSE D'ÉPOUSSETAGE

3. BUSE DE GONFLAGE

4. TUYAU D'ÉPOUSSETAGE

5. SUPPORT À PINCES DES ACCESSOIRES (COMPREND 3 ET 8)

6. BOYAU DE PROLONGATION

7. TUYAU COURT

8. BROSSE D'ÉPOUSSETAGE TRÈS LOCALISÉ

9. COUVERCLE DE DÉGONFLAGE

10. SAC POUR LES ACCESSOIRES

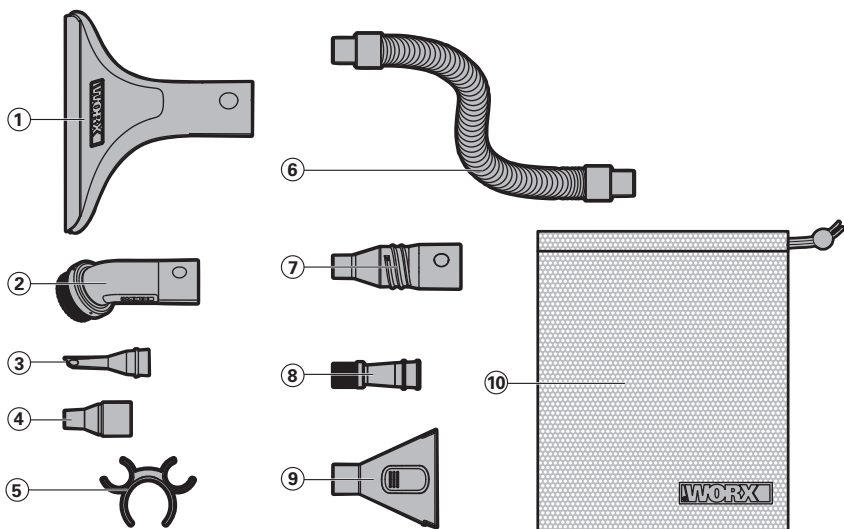

ASSEMBLAGE ET FONCTIONNEMENT

1. APPLICATION UTILISANT LE TUYAU COURT:

Raccordez le tuyau court (7) comme l'indique la Fig. A1:
Peut aussi être utilisé comme adaptateur pour les autres accessoires WORXAIR™.

Utilisez selon la Fig. A2:

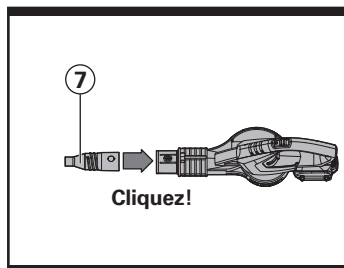

A1

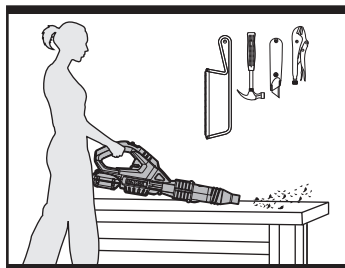

A2

2. APPLICATION UTILISANT LA BROSSSE D'ÉPOUSSETAGE:

Raccordez la brosse d'époussetage (2) comme l'indique la Fig. B1.

Utilisez selon la Fig. B2:

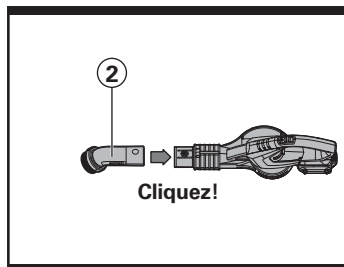

B1



B2

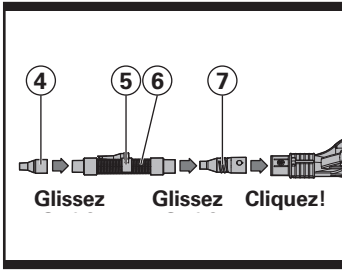

C1

3. APPLICATION UTILISANT LE TUYAU D'ÉPOUSSETAGE:

Raccordez le tuyau d'époussetage (4) comme l'indique la Fig. C1. Le tuyau court (7) et le boyau de prolongation (6) doivent être utilisés.

Utilisez selon la Fig. C2:

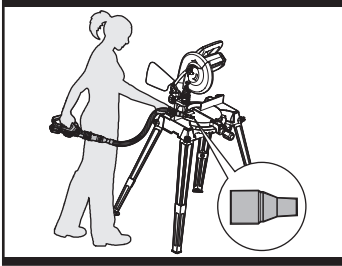

C2

10

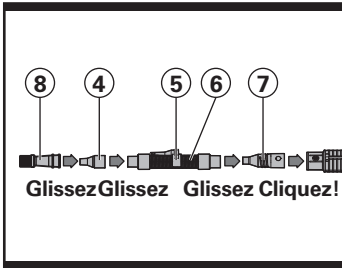

D1

4. APPLICATION UTILISANT LA BROSSÉ D'ÉPOUSSETAGE TRÈS LOCALISÉ:

Raccordez la brosse d'époussetage très localisé (8) comme l'indique la Fig. D1. Le tuyau court (7), le boyau de prolongation (6) et le tuyau d'époussetage (4) doivent être utilisés.

Utilisez selon la Fig. D2:

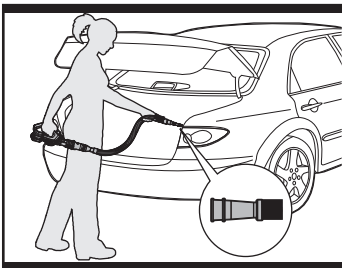

D2

5. APPLICATION UTILISANT LA BUSE DE GONFLAGE:

Raccordez la buse de gonflage (3) comme l'indique la Fig. E1. Le tuyau court (7), le boyau de prolongation (6) et le tuyau d'époussetage (4) doivent être utilisés.

Utilisez selon la Fig. E2:

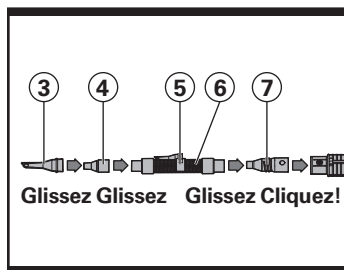

E1

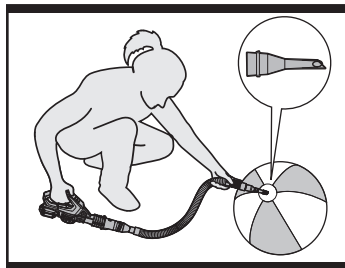

E2

6. APPLICATION UTILISANT LE COUVERCLE DE DÉGONFLAGE:

Raccordez le couvercle de dégonflage (9) comme l'indique la Fig. F1. Le boyau de prolongation (6) et le tuyau d'époussetage (4) doivent être utilisés. La buse de gonflage (3) ou le tuyau d'époussetage (4) peuvent être utilisés selon l'article.

Utilisez selon la Fig. F2:

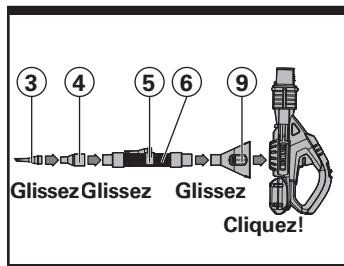

F1

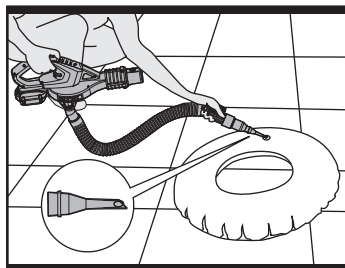

F2

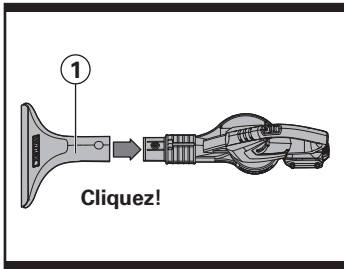

G1

7. APPLICATION UTILISANT LA BUSE LARGE:
Raccordez la buse large (1) comme l'indique la Fig. G1:

Utilisez selon la Fig. G2:

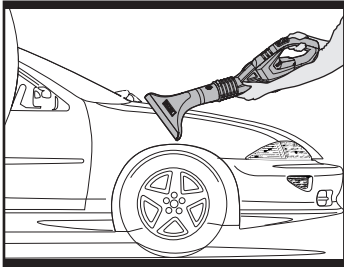

G2

ADVERTENCIA!

Lea este manual de seguridad importante para conocer por completo al producto.

PRECAUCIÓN!

El usuario deberá utilizar la indumentaria y equipamiento de seguridad adecuados al emplear este producto. Preste atención a las personas, mascotas y objetos que se encuentren en los alrededores. Inspeccione por completo el área en la que se utilizará la herramienta y extraiga todas las piedras, ramas, cables, huesos y otros objetos extraños.

1. BOQUILLA ANCHA

2. CEPILLO PARA EL POLVO

3. BOQUILLA INFLADORA

4. TUBO PARA EL POLVO

5. SOPORTE DE AGARRE DEL ACCESORIO (CONTIENE 3 Y 8)

6. MANGUERA DE EXTENSIÓN

7. TUBO CORTO

8. CEPILLO PARA DETALLES

9. CUBIERTA DEL DEFLACTOR

10. BOLSA DE ACCESORIOS

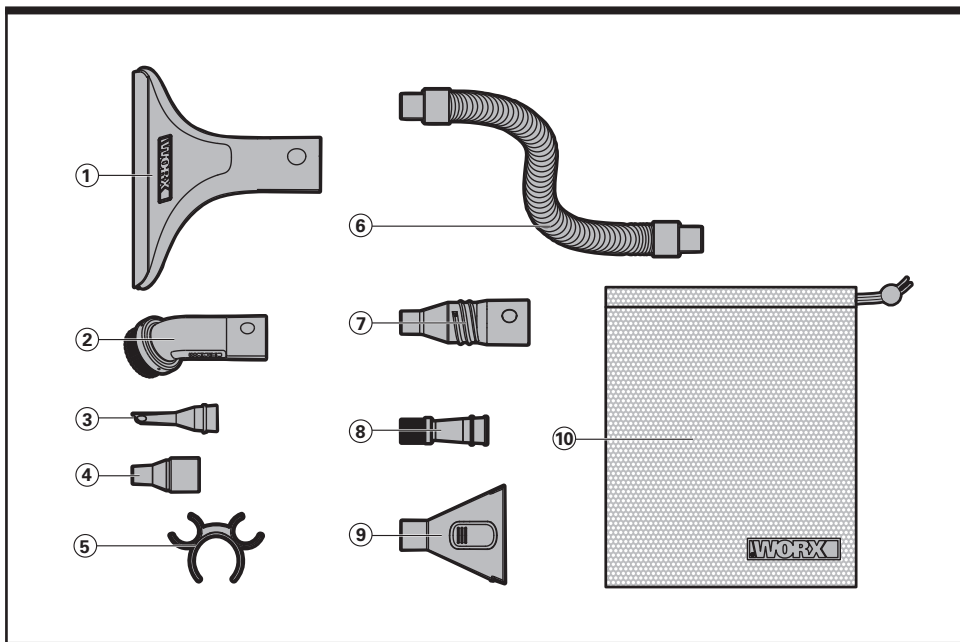

ARMADO Y FUNCIONAMIENTO

1. APLICACIÓN DEL TUBO CORTO: Adhiera el tubo corto (7) como lo muestra la fig. A1:

También se puede usar como adaptador para otros accesorios WORXAIR™.

Opere en conformidad con la Fig. A2:

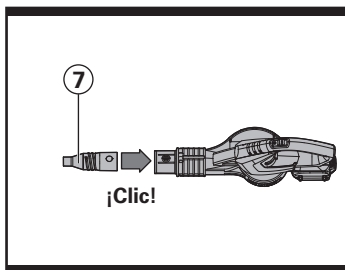

A1

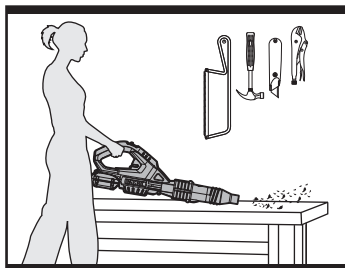

A2

2. APLICACIÓN DE CEPILLO PARA POLVO:

Adhiera el cepillo para polvo (2) como lo muestra la Fig. B1.

Opere en conformidad con la Fig. B2:

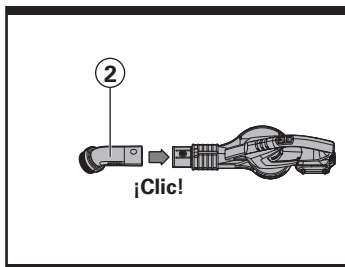

B1



B2

3. APLICACIÓN DE TUBO PARA POLVO:

Adhiera el tubo para polvo (4) como lo muestra la Fig. C1. Debe usar el tubo corto (7) y la manguera de extensión (6).

Opere en conformidad con la Fig. C2:

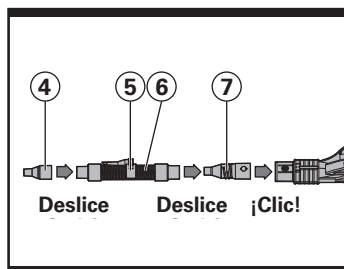

C1

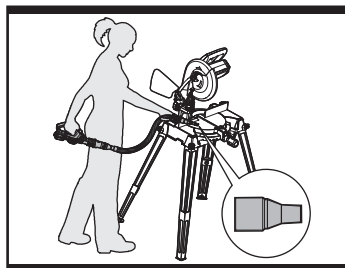

4. APLICACIÓN DEL CEPILLO PARA DETALLES:

Adhiera el cepillo para detalles (8) como lo muestra la Fig. D1. Debe usar el tubo corto (7), Manguera de extensión (6) y Tubo para polvo (4).

Opere en conformidad con la Fig. D2:

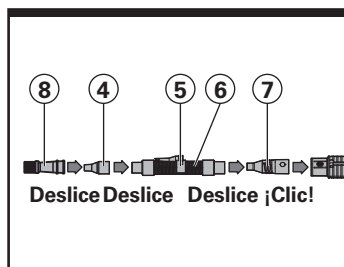

D1

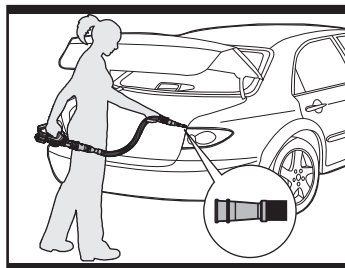

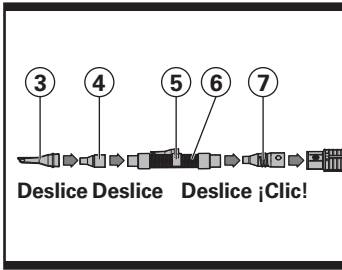

E1

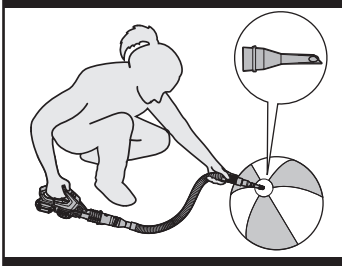

E2

5. APLICACIÓN DE BOQUILLA DE INFLADOR DE AIRE:

Adhiera la boquilla de inflador de aire (3) como lo muestra la Fig. E1. Debe usar el tubo corto (7), Manguera de extensión (6) y Tubo para polvo (4).

Opere en conformidad con la Fig. E2:

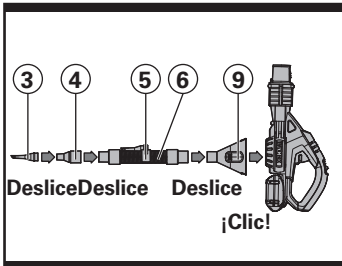

F1

6. APLICACIÓN DEL DEFLACTOR DE AIRE:

Adhiera la cubierta del deflactor de aire (9) como lo muestra la Fig. F1. Debe usar la manguera de extensión (6) y tubo para polvo (4). La boquilla de inflador de aire (3) o tubo para el polvo (4) pueden utilizarse según el objeto.

Opere en conformidad con la Fig. F2:

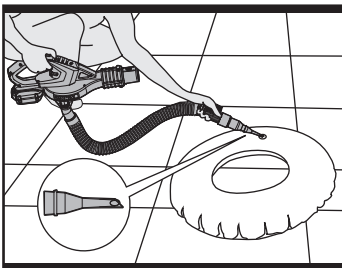

F2

7. APLICACIÓN DE LA BOQUILLA ANCHA:

adhiera la boquilla ancha (1) como lo muestra la Fig. G1:

Opere en conformidad con la Fig. G2:

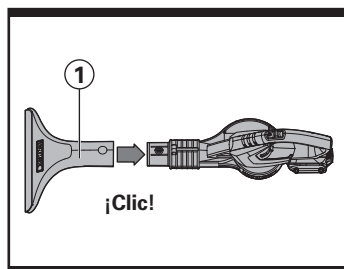

G1

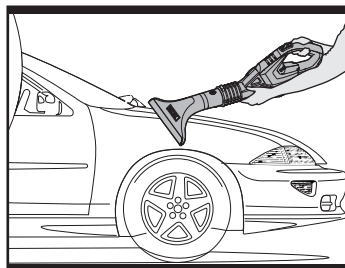

G2

WORX
it's your nature

Designed in Italy. Made in China
Conçu en Italie. Fabriqué en Chine
Diseñado en Italia. Fabricado en China

Copyright © 2013, Positec. All Rights Reserved.
2CBV80APK11000A0